

# LED Panel light

Premium Version (DLC)

**WeledPower**®



Original  
design

**VAC**

100-277



**5** Years  
warranty

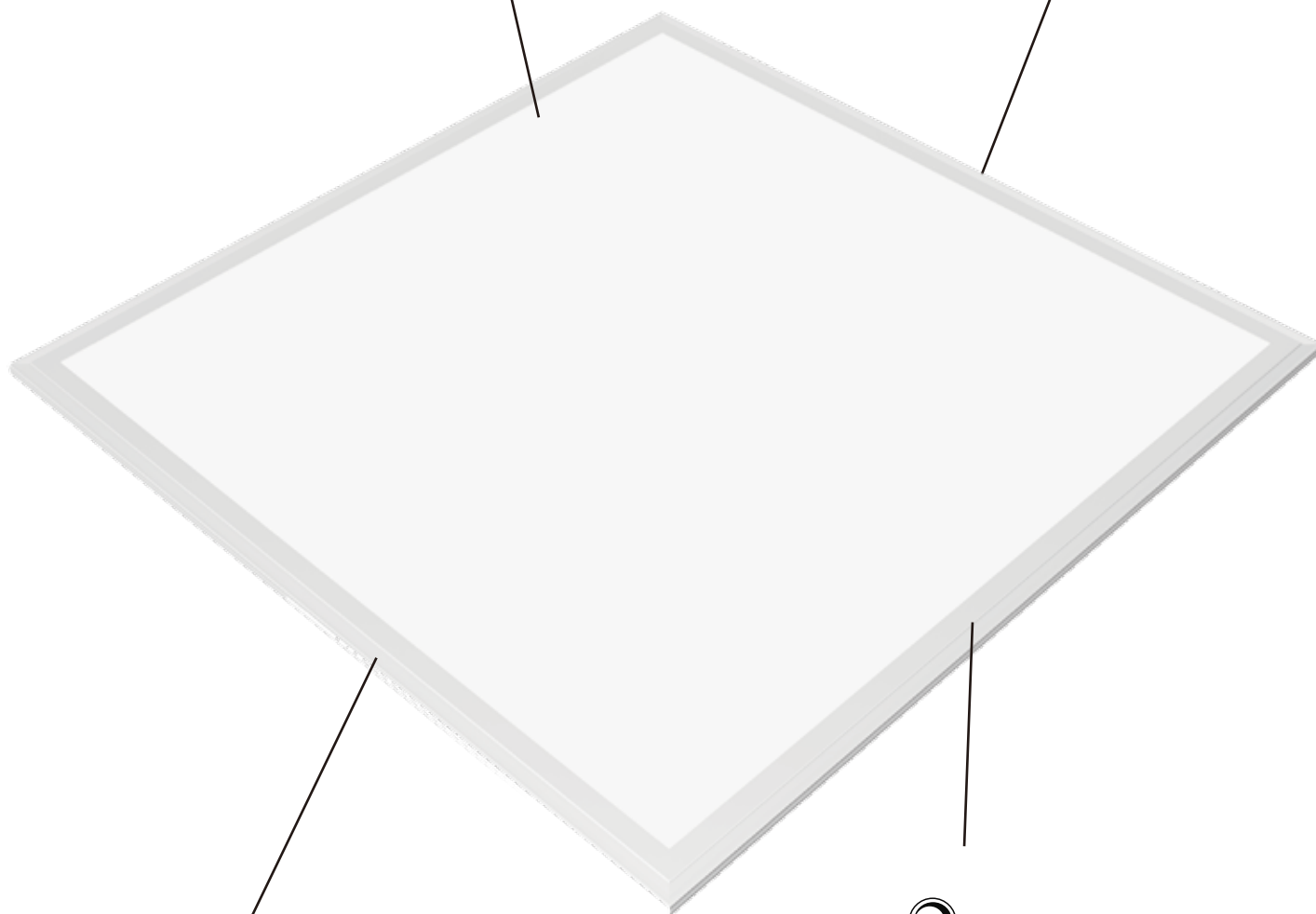

**130**  
**Lm/W**

**LM-80**

**CRI**  
**>80**

**PF**  
**≥0.95**



180°



0-10V  
Dimmers



Emergency

# Product Features

- 1. Delicately design creates uniform light distribution without hot spots, flicker or glare;
- 2. AL 6063 aluminum frame and good LGP with sophisticated craftsmanship provides magnificent long-lasting light output and elegant appearance;
- 3. 180lm/w LM-80-rated 2835/ 4014 SMD provides high efficacy to the panel light,
- 4. Power supply efficiency >92%, PF>0.95, Isolated power supply.
- 5. Approved by cETL No. 5001965, DLC listed, eligible for rebates;
- 6. Warranty 5 years

# Product Dimension

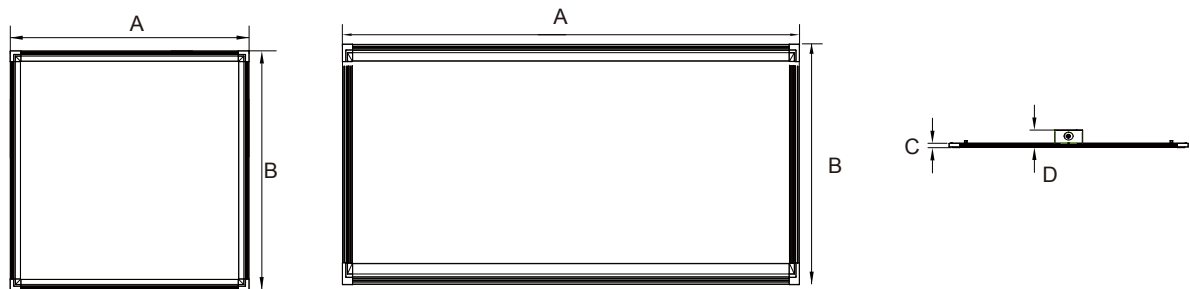

Size	A (inch)(mm)	B (inch)(mm)	C (inch)(mm)	D (inch)(mm)
2x2 FT	23.74" 603mm	23.74" 603mm	0.35" 9mm	1.69" 43mm
1x4 FT	47.76" 1213mm	11.81" 300mm	0.35" 9mm	1.69" 43mm
2x4 FT	47.76" 1213mm	23.74" 603mm	0.35" 9mm	1.69" 43mm

# Specification

Size	Power	Input Voltage	Dimmable	Input Current	PF	Light Efficacy	Ra	CCT
2X2	30W	AC100-277V	0-10V	0.3A	>0.95	130lm/w	80	3000-6000K
	40W	AC100-277V	0-10V	0.4A	>0.95	130lm/w	80	3000-6000K
1X4	40W	AC100-277V	0-10V	0.4A	>0.95	130lm/w	80	3000-6000K
2X4	50W	AC100-277V	0-10V	0.5A	>0.95	130lm/w	80	3000-6000K
	72W	AC100-277V	0-10V	0.72A	>0.95	130lm/w	80	3000-6000K

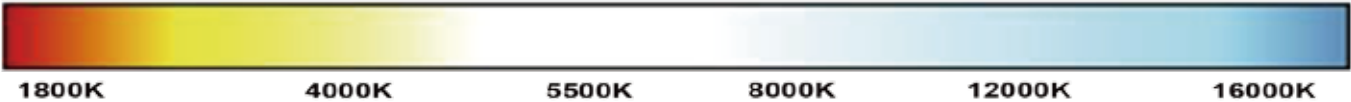

# Testing Report

2X2 LUMINOUS INTENSITY DISTRIBUTION DIAGRAM

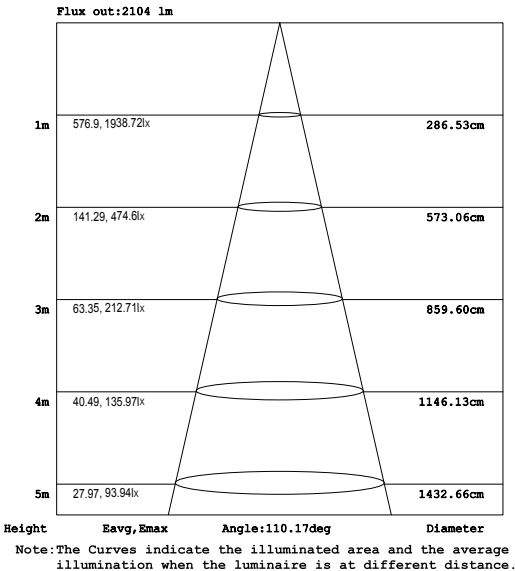
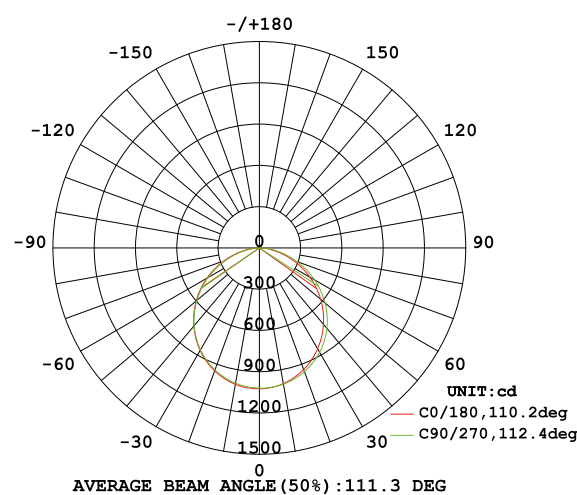

1X4 LUMINOUS INTENSITY DISTRIBUTION DIAGRAM

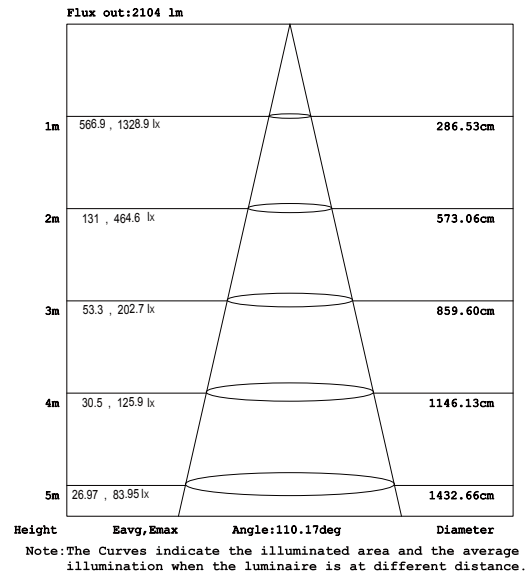
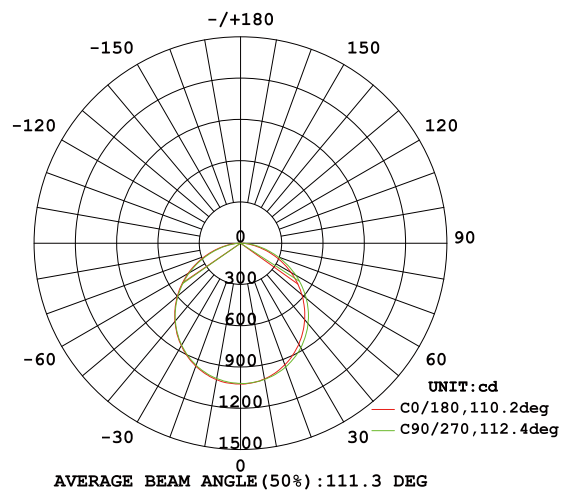

2X4 LUMINOUS INTENSITY DISTRIBUTION DIAGRAM

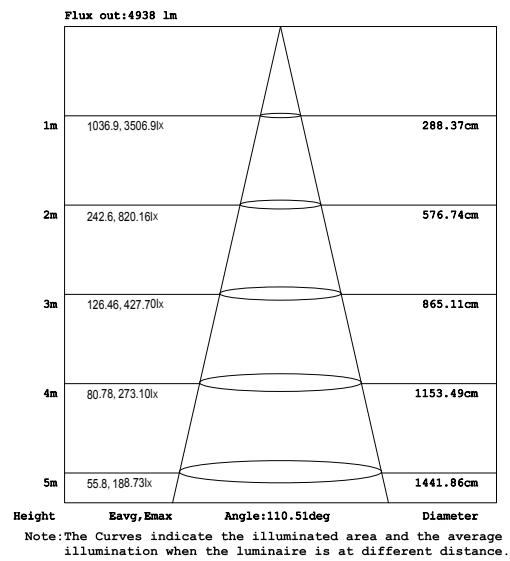
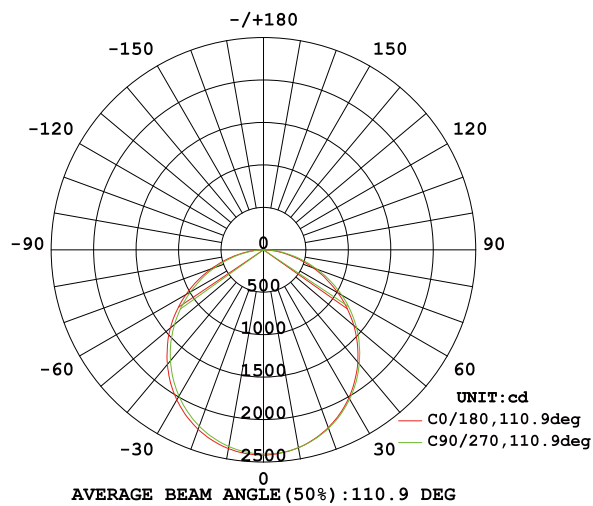

# Installation

## Recessed

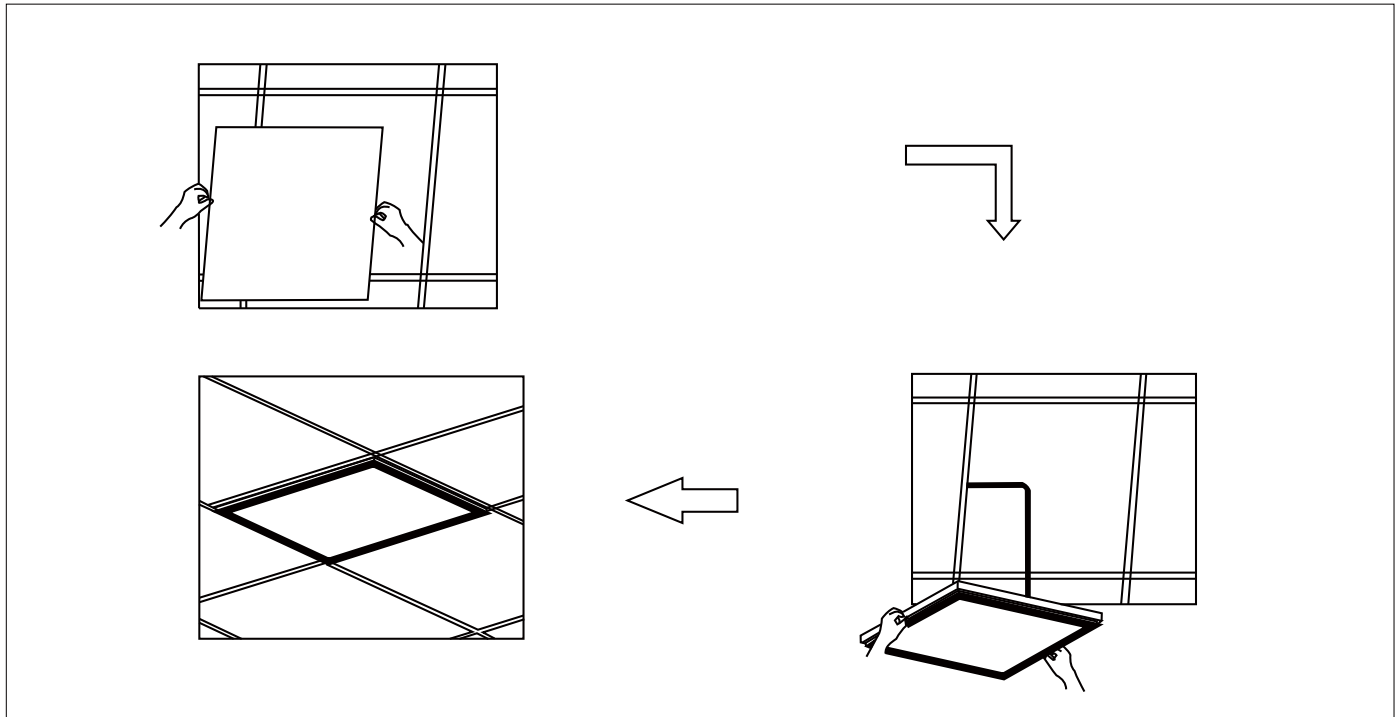

## Suspended

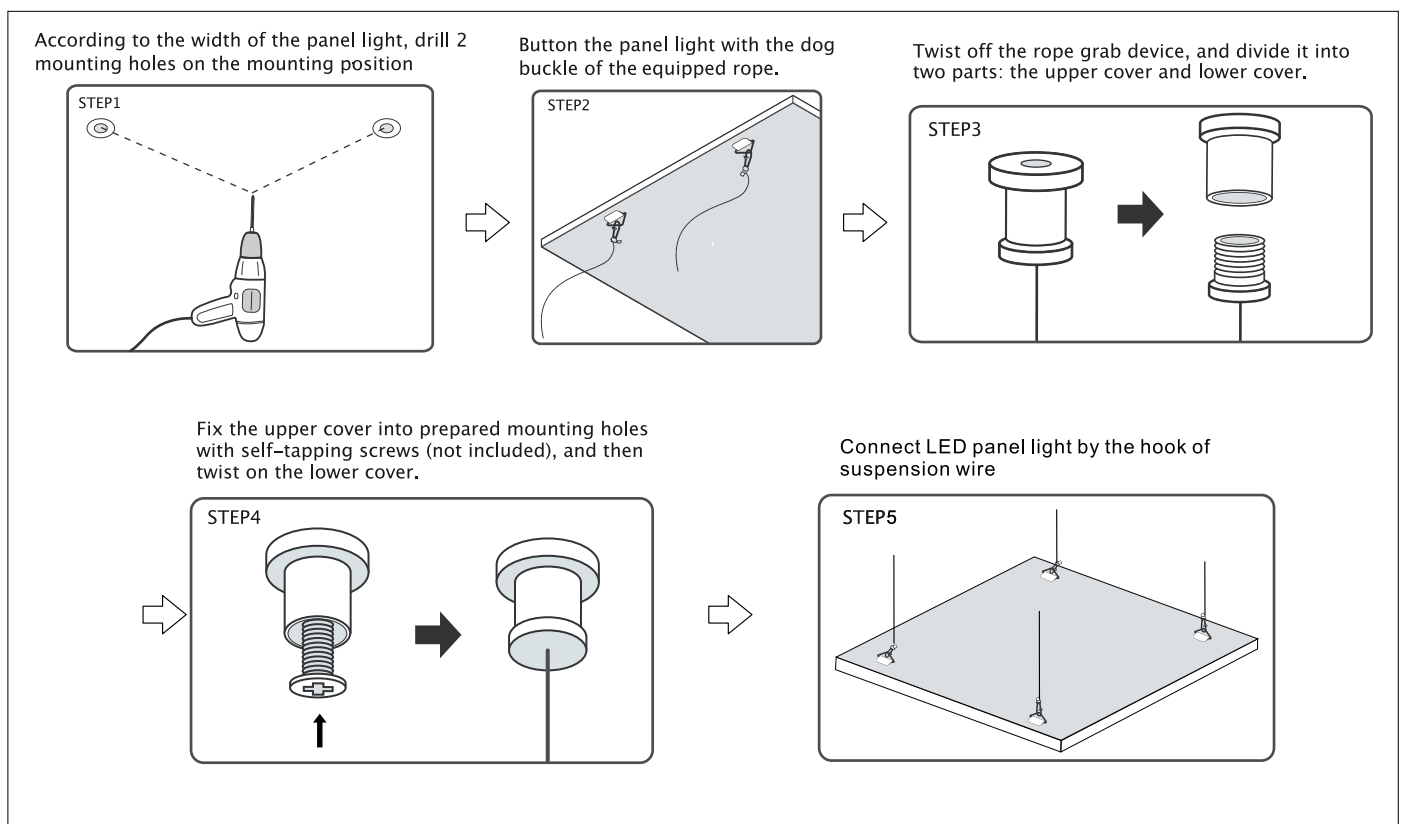

## Surface Mount

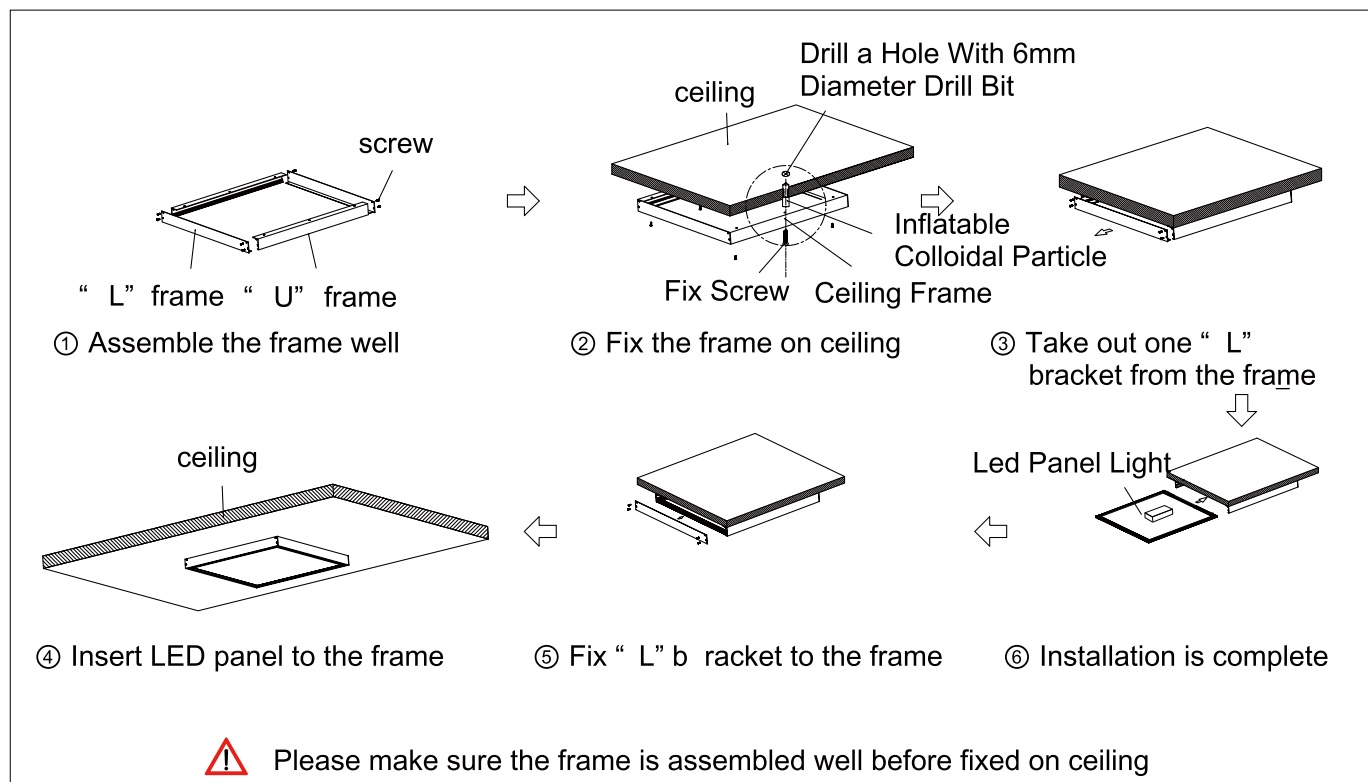

## Connection Mode

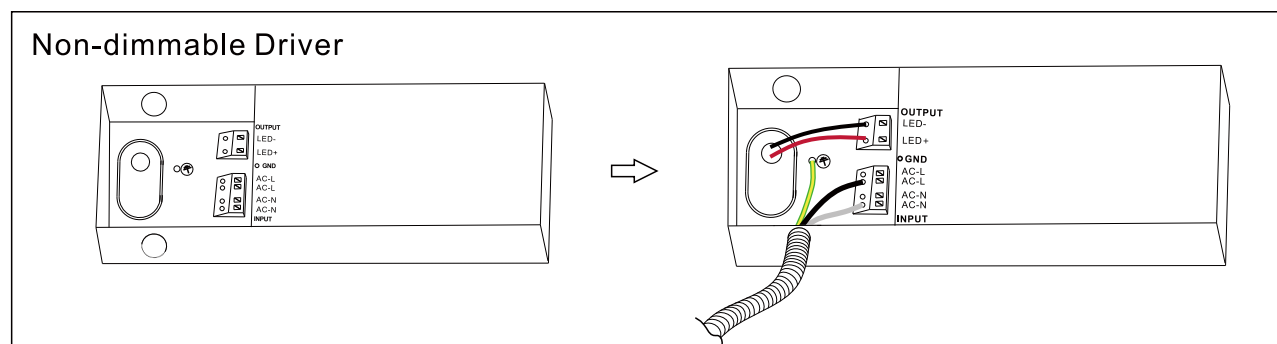
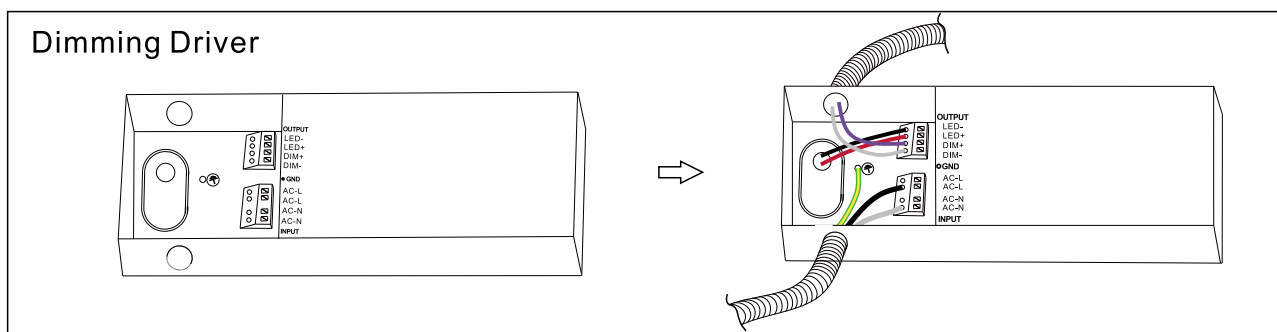

# Emergency LED Driver



RoHS

## Specifications:

<b>UL Recognized</b>	<b>Universal Input Voltage</b>
Factory Installation Only (Indoor and Damp)	100-277Vac,50/60Hz
<b>Output Voltage</b>	<b>Operating Ambient Temp Range</b>
30-42Vdc	0°C to+40°C (32°F to 104°F)
<b>Full Warranty</b>	<b>Dimensions</b>
5 Years	11.77"x3.81"x1.41"( 299mmx97mmx36mm )
<b>Weigh</b>	
2.75lbs(1.25kg)	

## AC Operation:

<b>Output Current (Optional)</b>	<b>AC Input Current</b>
800-1750mA	0.9A max.
<b>Maximum Input Power</b>	<b>Power Factor@Max Load</b>
75W max.	>0.90
<b>Surge Protection</b>	<b>Dimming</b>
(Combi-Wave,KV)1.0KV	0-10Vdc,PWM

## Emergency Operation:

AC Input Current		AC Input Power Rating			
90mA Maximum(Charging Only)		6.0W Maximum(Charging Only)			
Recharge Time		Battery			
≥ 24 Hours		lithium battery			
Battery Charging Current		Output Current t(Optional)			
250mA max.		270-550mA			
IlluminationTime		Test Switch Charging Indicator Light			
90 minutes Emergency		Illuminated Test Switch			
Output Power (Emergency)					
Driver and Emergency Correspond Form					
AC Input Power	30W	40W	50W	60W	75W
Emergency Power	10Wmax.	12Wmax.	15Wmax.	18Wmax.	20Wmax.

Dimensions:

Case-11.77"x3.81"x1.41" (299mmx97mmx36mm)

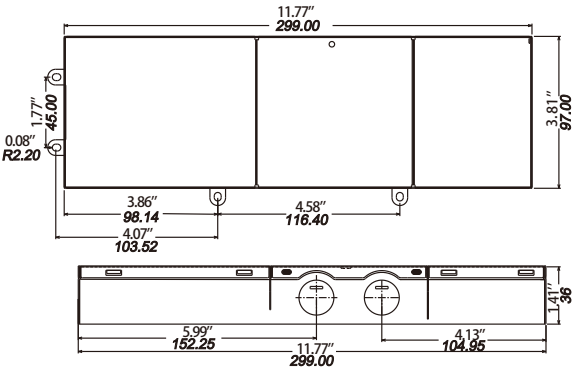

Wiring Diagram:

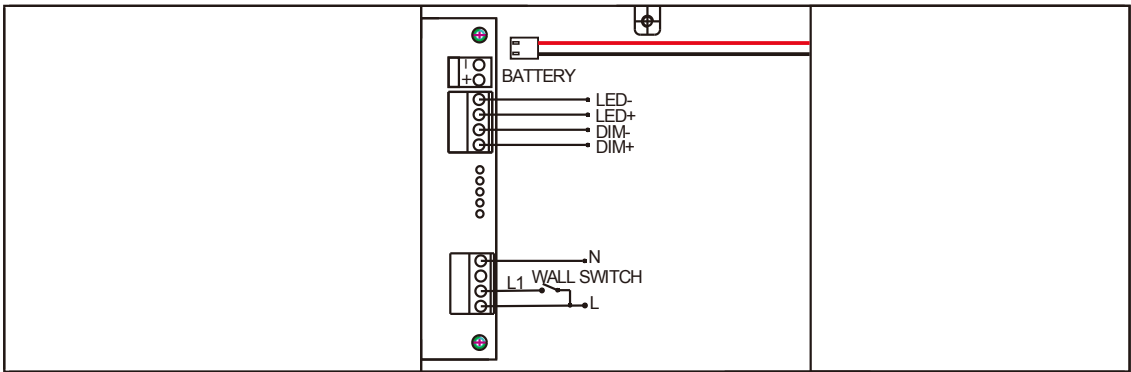

NOTE:WALL SWITCH:Control switch light.

- 1.The power supply cannot insert the battery packet into the mainboard connector before installation; It has been installed to allow the battery package to be inserted into the mainboard connector before the AC voltage is completed.
- 2.Test accessory leads-observe proper polarity wiring.

Display Status:

Operating Condition	Red	Green
Charging	ON	OFF
Emergency	OFF	ON

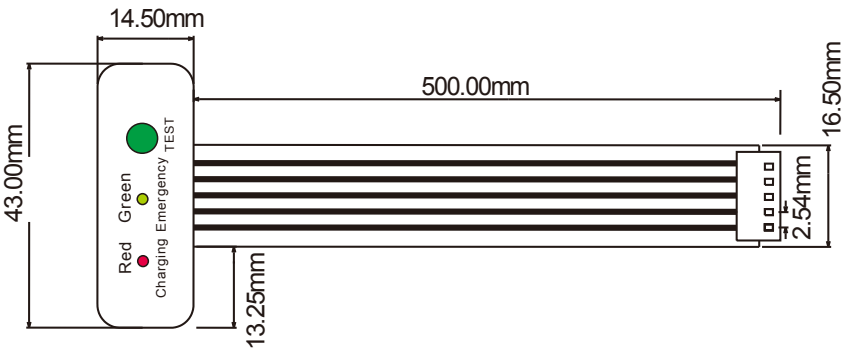



# Packing /weight

Size	Outer Carton Size (LxWxH)	Qty/Carton (pcs)	Net weight (kg)(lbs)	Gross weight (kg)(lbs)	20GP (QTY)	40GP (QTY)
2x2FT	(650*260*653mm) (25.59"x10.24"x25.71")	6pcs	3.5kg 7.72lbs	23.5kg 52.47lbs	1440	3360
1X4FT	(1260*176*350mm) (49.61"x6.93"x13.78")	4pcs	3.4kg 7.50lbs	15.0kg 33.07lbs	1300	3160
2X4FT	(1260*176*653mm) (49.61"x6.93"x25.71")	4pcs	6.7kg 14.77lbs	29.0kg 63.93lbs	640	1728

# Packing

